

**Model 6380**  
**“K” Type Female Mini-Connector**  
**“Do It Yourself”**

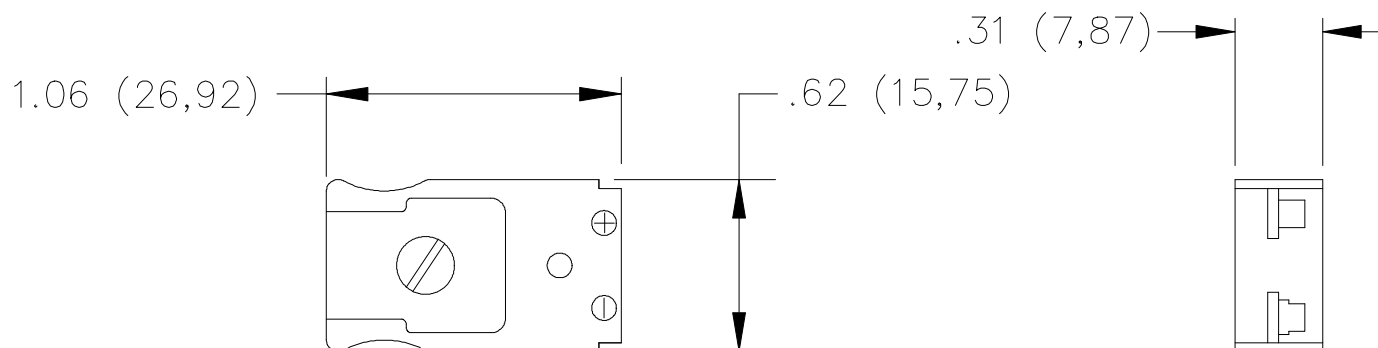

**FEATURES:**

- Molded in contacts assure precision alignment.
- Matching thermocouple alloys reduce EMF.
- Channel design isolates wires for clear, strong signals.
- Make your own extension labels using Model 6372 and KX extension wire.

**MATERIALS:**

Insulator – Yellow, Hytrel 4776.

Contacts – Material matched for use with “K” type Chromel/Alumel thermocouples.

**RATINGS:**

Maximum Ambient Temperature - 400°F. (205°C.).

Maximum Wire Size – 20AWG (solid), 22 AWG (stranded)

**ORDERING INFORMATION:** Model 6380

Note: For low voltage environments. Do not exceed 30VAC/60VDC.

All dimensions are in inches. Tolerances (except noted): .xx = ±.02” (.51 mm), .xxx = ±.005” (.127 mm).  
 All specifications are to the latest revisions. Specifications are subject to change without notice.  
 Registered trademarks are the property of their respective companies. Made in USA

### ASSEMBLY INSTRUCTIONS

1. Using a flat tip screwdriver, remove lid from connector.
2. Cut back KX extension wire jacket (if applicable) 5/8”, strip back individual wires (Red & Yellow\*) 1/4”.
3. Remove the elastomer strain relief from the connector. Insert Red & Yellow wires into the strain relief until flush with the extension wire outer jacket (5/8”).
4. Loosen the two wire terminal screws (Approximately 3 1/2 turns counter clockwise) using a small flat tip screwdriver.
5. Insert the stripped Red wire under the (-) terminal screw, and the Yellow wire under the (+) terminal screw. Tighten down the two terminal screws.
6. Install the lid and tighten down the lid screw.

\*Color may vary outside of the USA.

All dimensions are in inches. Tolerances (except noted): .xx = ±.02” (.51 mm), .xxx = ±.005” (.127 mm).  
All specifications are to the latest revisions. Specifications are subject to change without notice.  
Registered trademarks are the property of their respective companies. Made in USA